

PRIMINER

GT11

High Speed Double Column Center





Technical Specifications	GT11
Table size	1200×700 mm
X/Y/Z Travel	1150 / 700 / 520 mm
X/Y/Z Rapid feed	24 m/min
Spindle taper	HSK A63
Spindle speed	18000 rpm

GT11

40 pockets chain type tool changer

Roller type linear guideways on three axis

Linear scales on X/Y/Z axis

Built-in spindle HSK A63 18000rpm

Two screw type and one chain type chip conveyor

Oil cooling through ballscrew (optional)

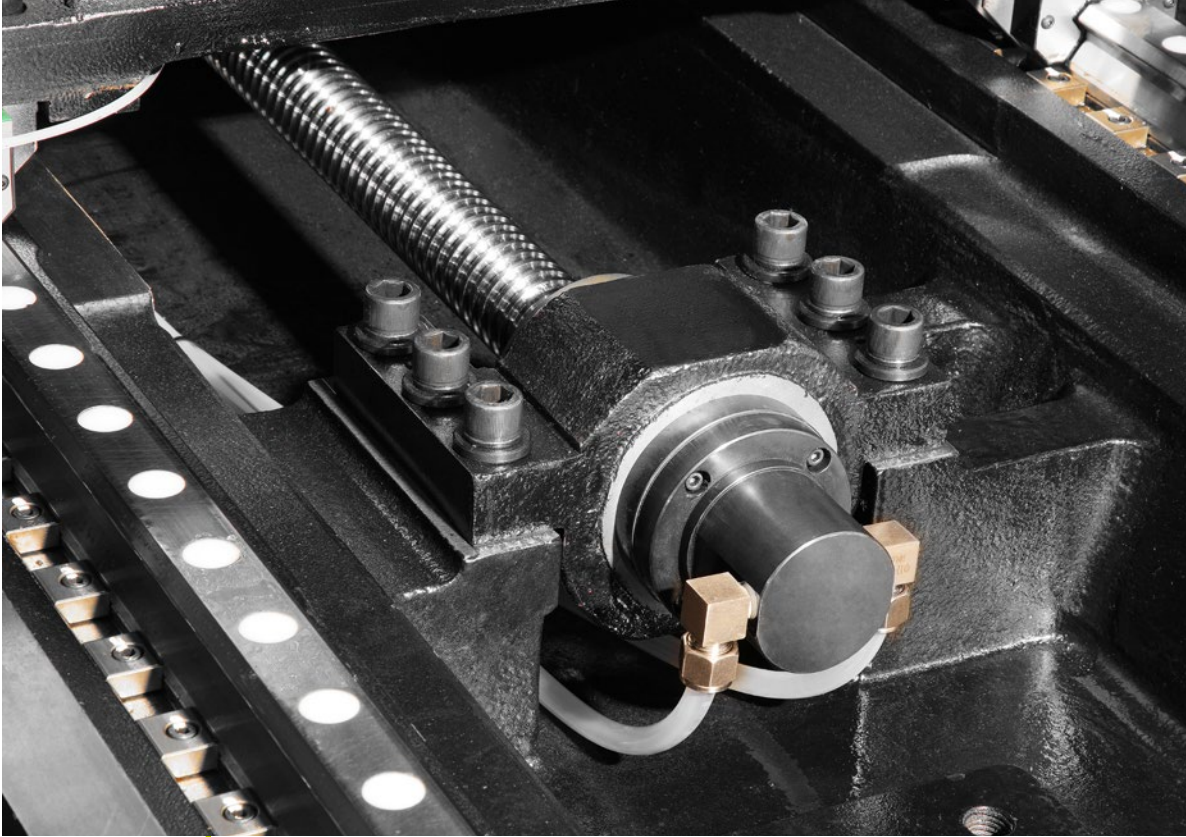

Oil cooling through ballscrew(optional)



Heidenhain linear scales on X/Y/Z axis

HIGH PRECISION

CHAIN TYPE TOOL CHANGER



- 40 pockets chain type tool changer
- Tools can be loaded and unloaded during machining
- User-Friendly door and button make the loading and unloading of workpiece easier
- High production efficiency

Technical Specification

- Number of tools 40
- Max.tool diameter $\Phi 78/\Phi 125\text{mm}$ (next release)
- Max.tool length 300 mm
- Max.tool weight 8 kg



BLUM MEASURING SYSTEM

Universal High-Speed touch probe with multidirectional measuring mechanism

- ✓ Detection of workpiece position
- ✓ Correction of workpiece orientation
- ✓ Thermal compensation of the machine tool
- ✓ Contour measurement

Your benefit:

- ✓ Measuring speed up to 3 m/min
- ✓ Precise, non-lobing touch characteristics
- ✓ No-wear, optoelectronic measuring mechanism
- ✓ Use of two measuring systems with one IR receiver
- ✓ Extended battery life
- ✓ Precise measurement even with coolant
- ✓ Proven and robust design

Highlights

- ✓ Proven high-precision laser measuring system;
- ✓ Non-contact, optical tool measurement;
- ✓ 100 % reliable due to BLUM protection system

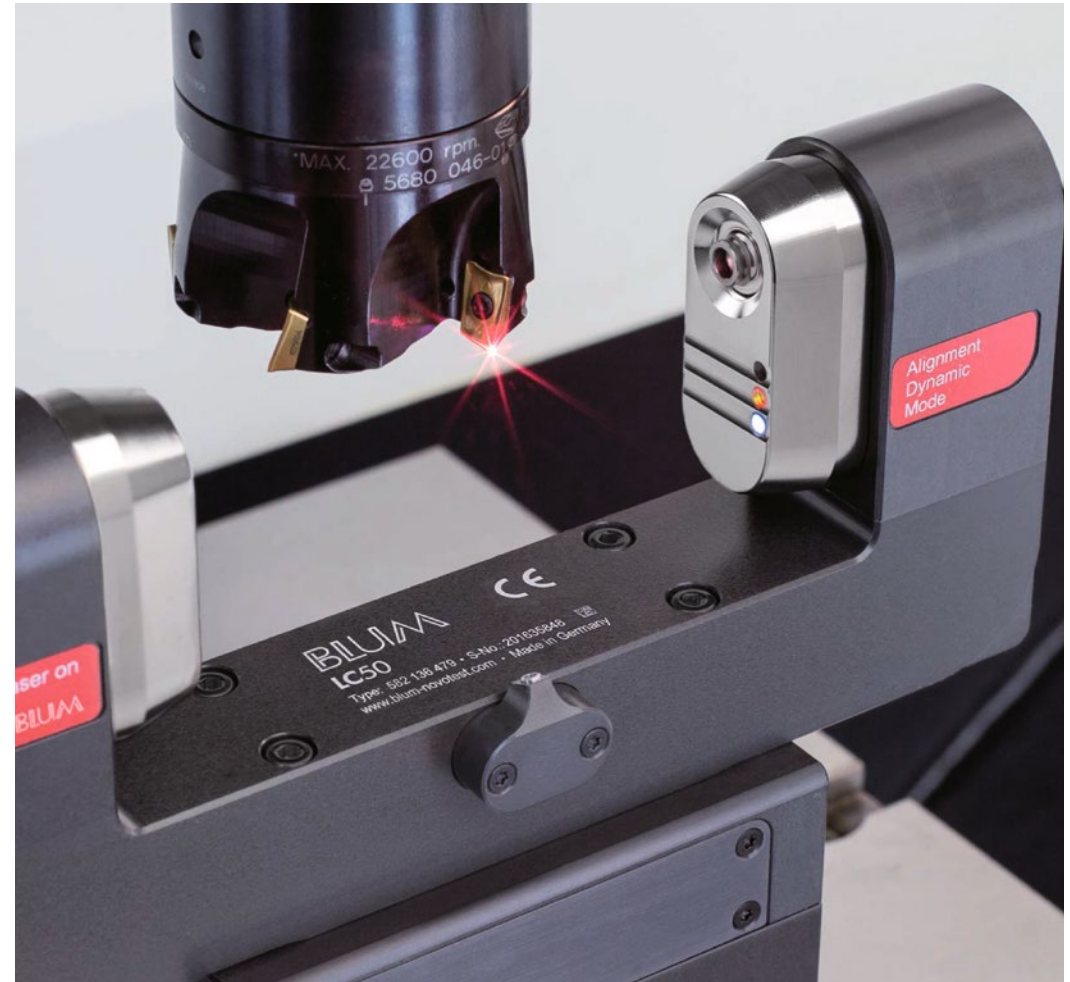



HEIDENHAIN TNC 640

The TNC contouring control for milling and milling-turning machines

Key features:

Intelligent-Dynamic Precision Machining

- ✓ Dynamic Collision Monitoring (DCM)
- ✓ Dynamic Efficiency
- ✓ Active Chatter Control (ACC)
- ✓ Adaptive feed control (AFC)
- ✓ Machine any contour slot with trochoidal milling

Fast and reliable machining at high contour fidelity

- ✓ Optimal tool guidance by the TNC 640

Programming, Editing, Testing and Automated machining

- ✓ A full range of possibilities with the TNC 640
- ✓ Graphical support in any scenario
- ✓ Straightforward function keys for complex contours
- ✓ Programming free contours and Data Matrix codes
- ✓ Easy calibration of rotary axes with KinematicsOpt

Tool measurement and Workpiece measurement

- ✓ Measuring length, radius, and wear inside the machine
- ✓ Setup, preset setting, and measuring with touch trigger probes
- ✓ Machining and measuring 3-D contours
- ✓ The TNC 640 makes setup easy

Open to outside information

- ✓ Processing CAD files with the TNC 640
- ✓ The TNC 640 programming station
- ✓ Uniformly digital job management with Connected Machining
- ✓ The TNC 640 makes setup easy

SIEMENS SINUMERIK 828D

The perfect solution for all performance classes

New Panel Processing Unit

- ✓ Higher processor performance
- ✓ Digital Input with higher voltage stability
- ✓ 1GB Ethernet interface X130
- ✓ Pull-relief for the DRIVE-CLiQ and PN cables
- ✓ More robust touch-operation 15,6" PPU290.4

Features for milling Cogging torque compensation and 2nd channel for milling

- ✓ System integrated function
 - Drive-based function SINAMICS
- ✓ Automatic measure of the cogging torque
- ✓ Pre-control of periodic repetitive torque ripple
- ✓ Function available for rotative-, linear- and torque motors
- ✓ 2nd Channel Milling
 - For both machining and handling & robot purpose

Nodding Compensation ECO/Advanced and Advanced Position Control ECO

- ✓ Intelligent control based compensation
 - New developed compensation algorithm
- ✓ System integrated function
 - As a CNC and HMI feature
- ✓ Scalable function in 3 steps
 - ECO
 - Advanced
 - Complete Cycle
- ✓ Commissioning support with HMI masks
 - Additional input mask from SINUMERIK Operate

Higher speed, more accurate for the entry level

Tool Ident Connection

Jerk Adaption

Top Speed plus

Intelligent Load Control (ILC)

Intelligent Dynamic Control (IDC)



TECHNICAL SPECIFICATIONS

Technical Specifications	GT11	
Table		
Table size	1200×700 mm	
T-slot (width x number x distance)	18×6×100 mm	
Max. load	1500 kg	
Travel		
X/Y/Z Travel	1150 / 700 / 520 mm	
Spindle nose to table	140-660 mm	
Spindle		
Spindle taper	HSK A63	HSK A63
Spindle motor power and torque	30/36 kW, 85/102 Nm	30/36 kW, 100/120 Nm
Spindle speed	18000 rpm	16000 rpm
Feed		
Rapid feed X/Y/Z	24 m/min	
Cutting speed X/Y/Z	1-12000 mm/min	
Tool changer		
Number of tools	40 pcs	
Max. tool length	300 mm	
Max. tool diameter	Φ78 / Φ125 mm	
Max. tool weight	8 kg	
Accuracy(VDI 3441 Full travel)		
Positioning accuracy	0.006 mm	
Repeatability accuracy	0.003 mm	
Dimensions & Weight		
Dimensions	3680×3180×3090 mm	
Weight	9000 kg	

STANDARD/OPTIONAL CONFIGURATION

● Standard ○ Optional

Configurations	Standard	Optional
Full enclosed splash guard	●	
Built-in spindle HSK A63 18000rpm,30/36KW, 85/102Nm	●	
40 pockets chain type tool changer	●	
Chip conveyor (two screw type and one chain type)	●	
Linear scales on X/Y/Z axes	●	
Air-conditioned electrical cabinet	●	
High precision spindle water cooler	●	
Ethernet,CF card and USB interface	●	
Centralized automatic grease lubrication system	●	
LED workinglamp	●	
BUILT-IN SPINDLE HSK A63 16000RPM, 30/36KW, 100/120NM		○
CTS Coolant throught spindle+ATS		○
Tool probe		○
Workpiece probe		○
Oil skimmer		○
Minimum Quantity Lubrication system		○
Coolant Cooling system		○
Oil cooling through ballscrew		○
Extra 200GB SSD program memory		○
End of program light	●	
Electronic handwheel	●	
Tool box	●	
Leveling bolts and blocks	●	
Air blast during cutting	●	
Coolant gun	●	
Air gun	●	
User Manual	●	

TORQUE DIAGRAM

HSK A63 - 18000 rpm

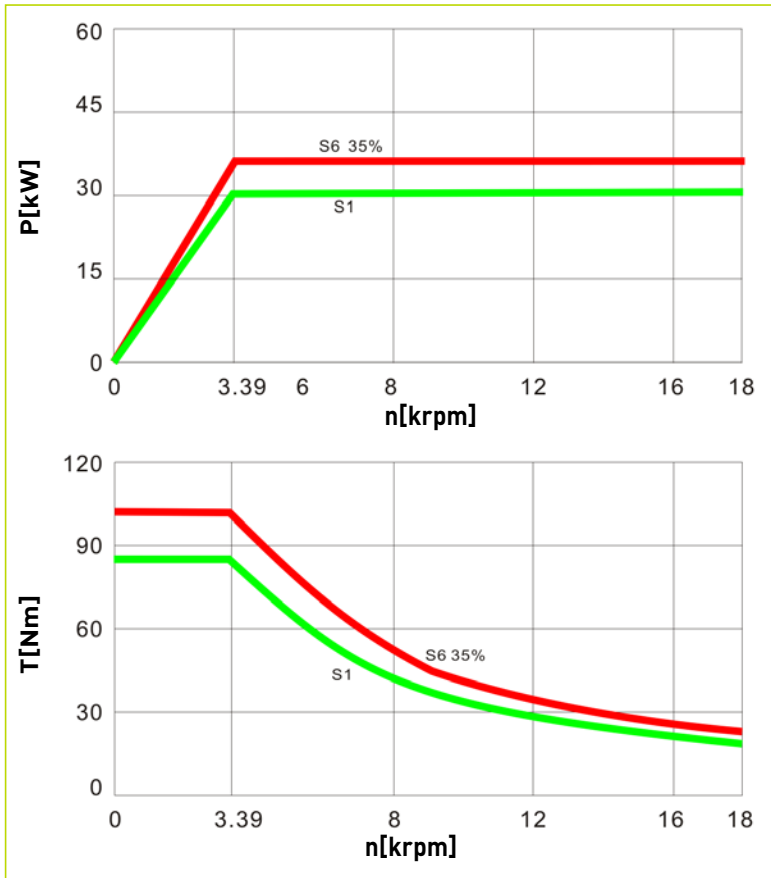

30/36 kW 85/102 Nm

HSK A63 - 16000 rpm

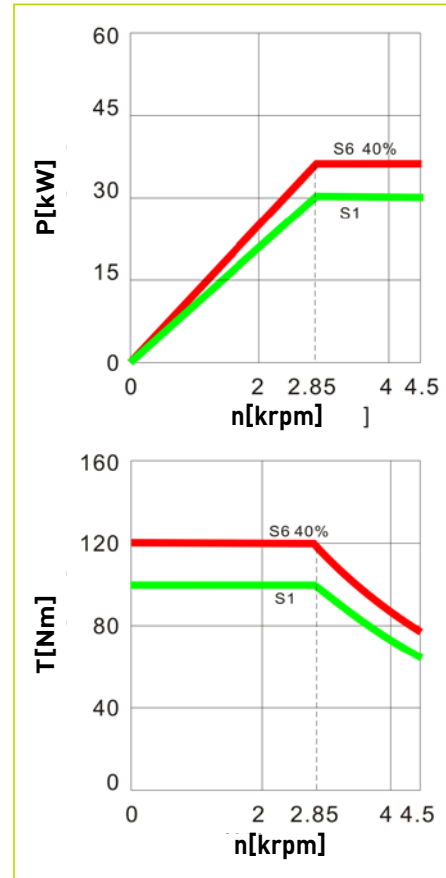

Y connection 4500 rpm
30/36 kW 100/120 Nm

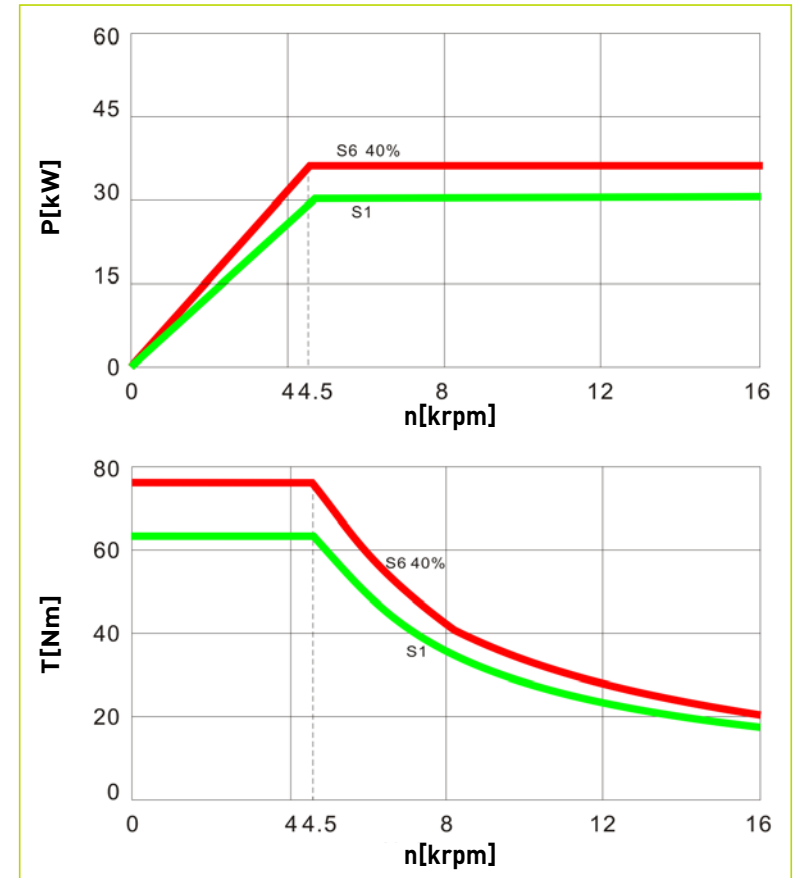

△ connection 16000 rpm
30/36 kW 63.6/76.3 Nm

DIMENSIONS

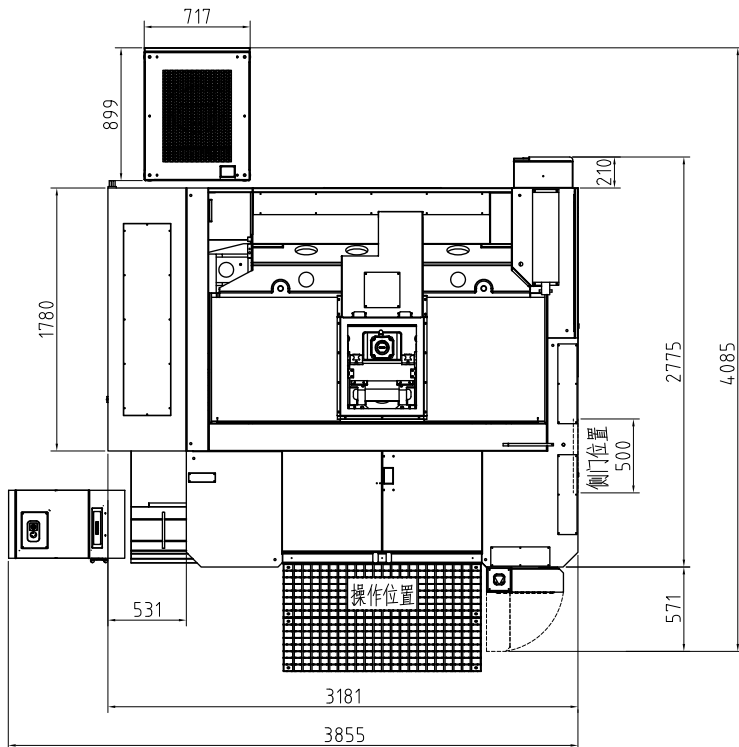
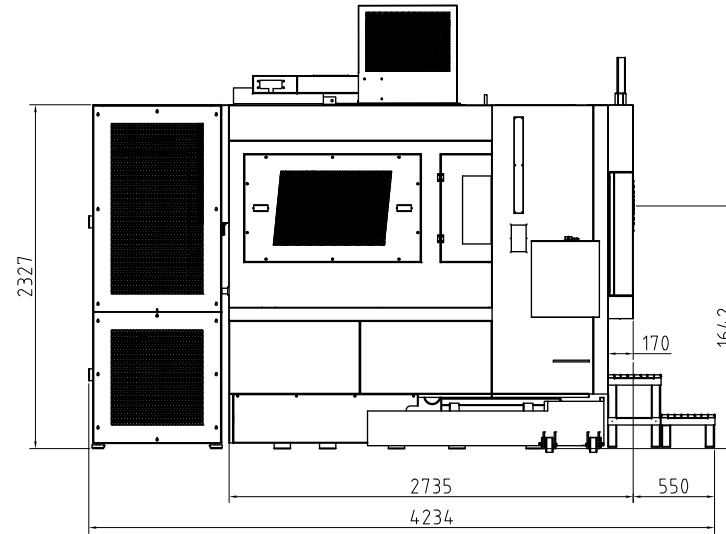
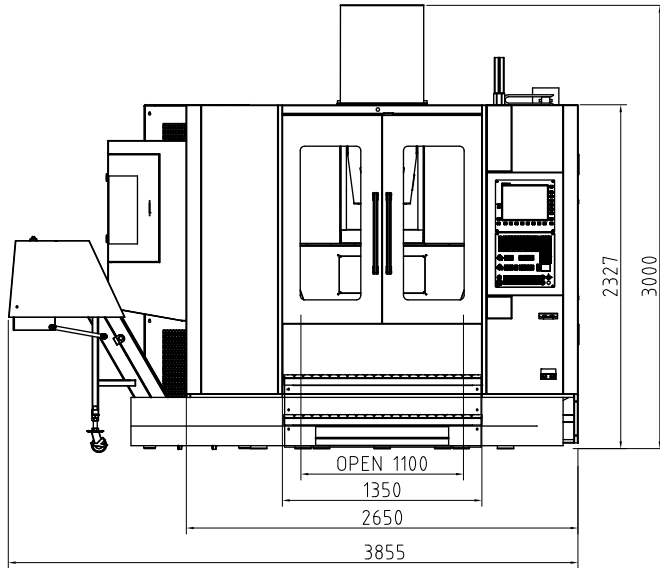

OUR SUPPLIERS

HEIDENHAIN SIEMENS



NSK



BLUM
focus on productivity



FAG



OPTIONS



CTS COOLANT THROUGH SPINDLE+ATS

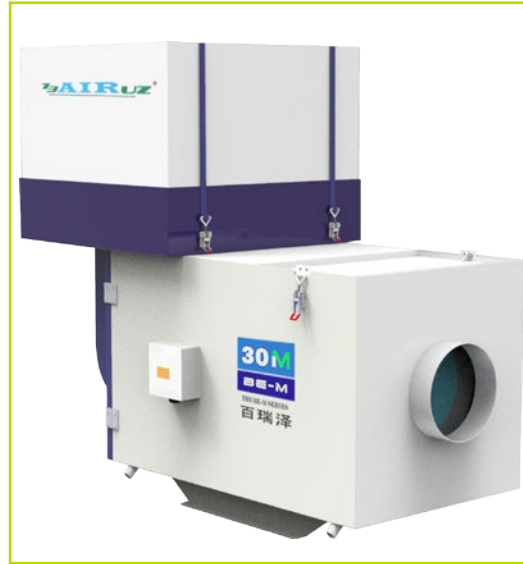

OIL MIST COLLECTOR



TOOL AND WORKPIECE PROBE

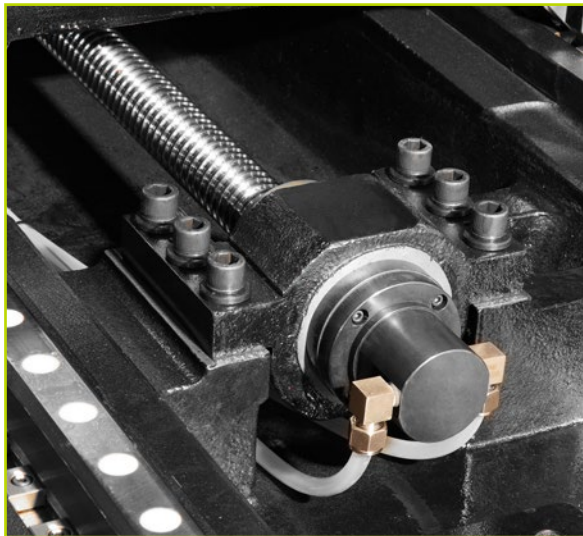

OIL COOLING THROUGH BALLSCREW



COOLANT COOLING SYSTEM



VISIPOINT



OIL SKIMMER

WORKPIECE SAMPLES

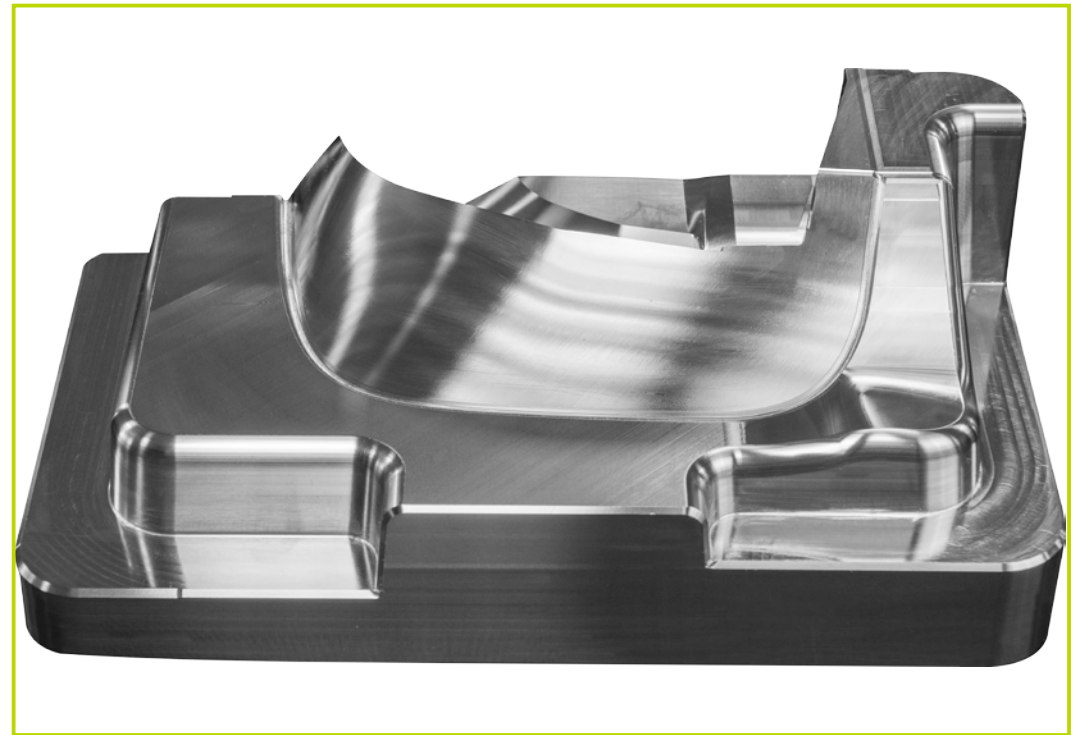
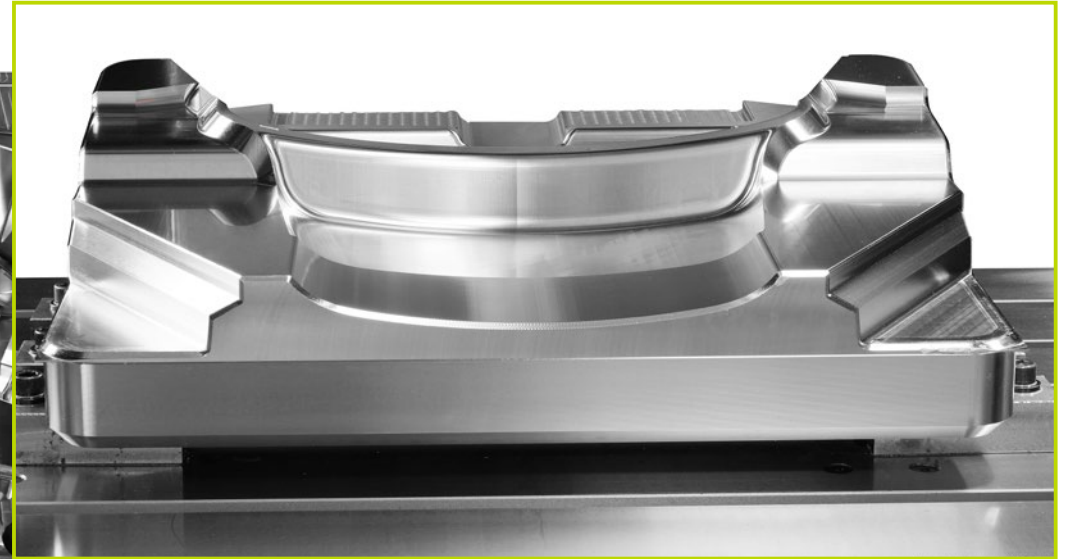
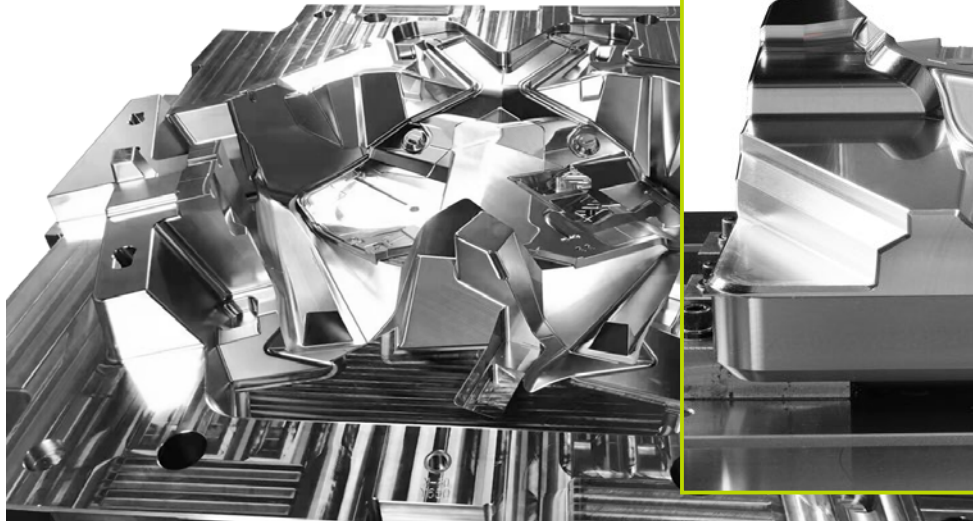





IMINER Global TEAM

PRIMINER Solutions



hyperMILL

DIJET NS TOOL

SolidCAM
The Leaders in Integrated CAM

GÜHRING



PL LEHMANN



HAIMER



SCHUNK



Blaser
SWISSLUBE



REGO-FIX

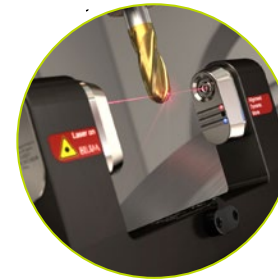

BLUM
focus on productivity



Workpiece measuring by CMM

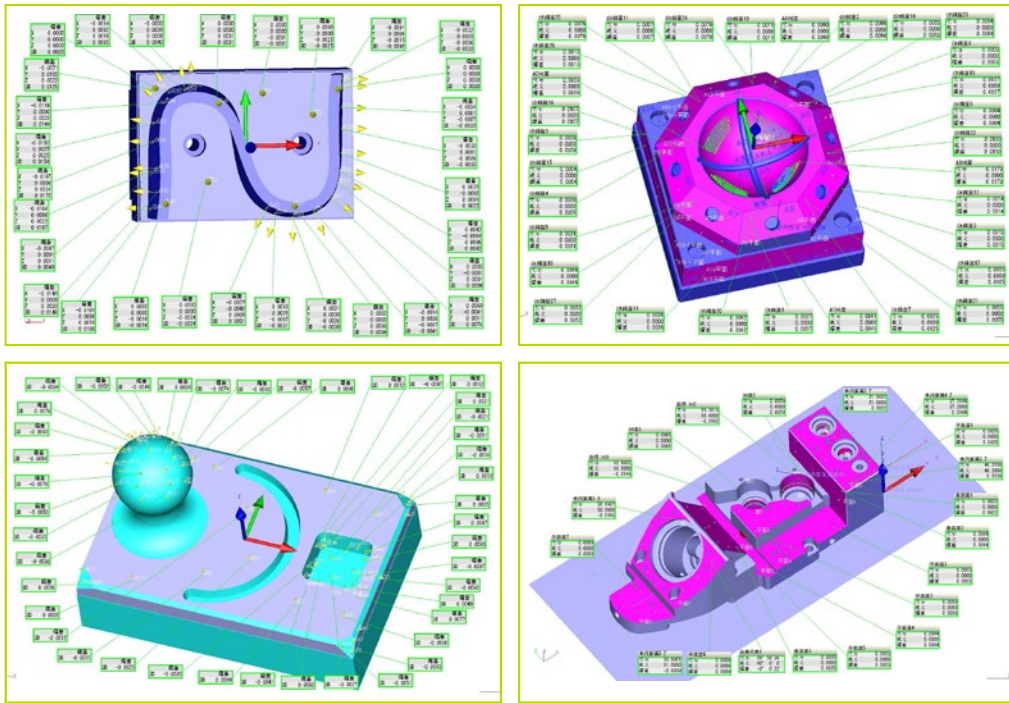

PRIMINER

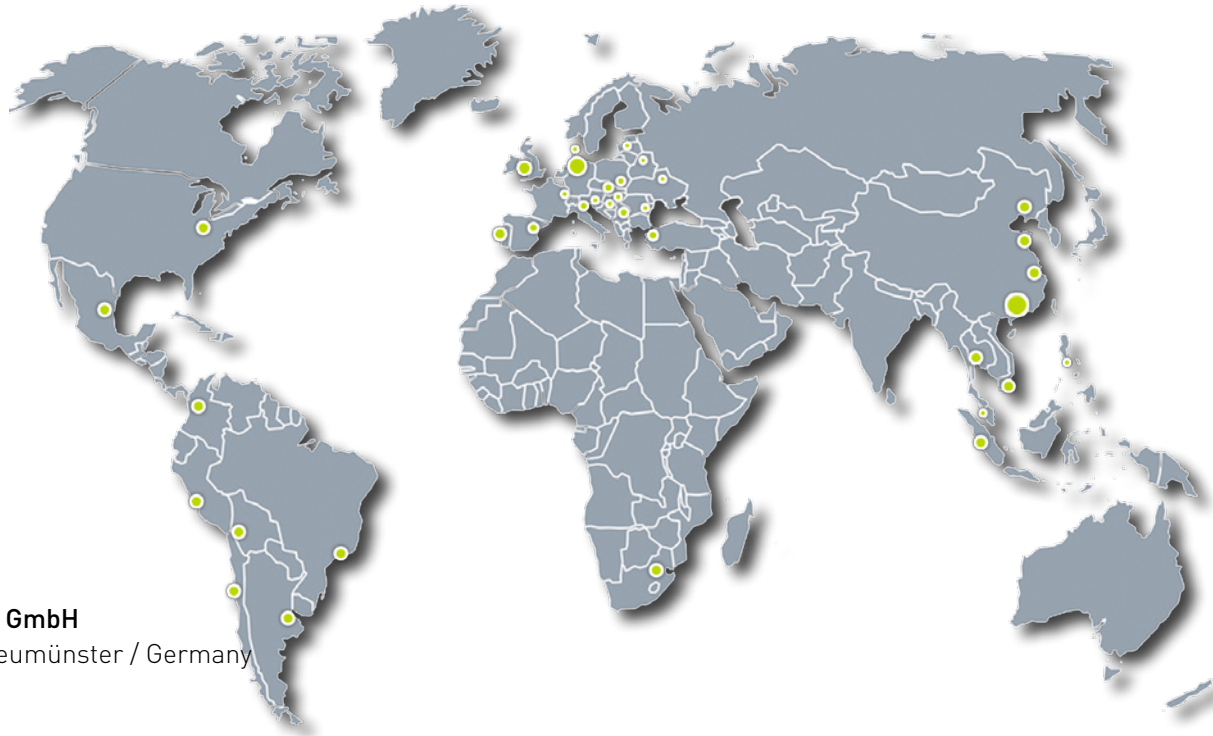

PRIMINER Werkzeugmaschinen GmbH

Tungendorfer Str.10 · D-24536 Neumünster / Germany
Tel: +49 (0) 4321-53 9946 -0
Fax: +49 (0) 4321-25 2003 -90
E-mail: info@priminer.de

PRIMINER SOUTH EAST EUROPE · PRIMINER d.o.o. BEOGRAD

Vladimira Popovica 38-40 · GTC - 11070 Beograd / Srbija
Tel: +381 69 702 705
Fax: +381 11 715 69 00
E-mail: office@priminer.de

PRIMINER MACHINE TOOLS DONGGUAN CO., LTD

XinRuYi Industrial Park, Fuxing Road, Xingguang Village, Huangjiang Town, Dongguan, P.R.China
Tel: +86 769 838 490 61
Fax: +86 769 838 490 62
E-mail: sales@priminer.de

www.priminer.de